



## Fiber Optic Attenuators

Attenuators are used in telecom networks to reduce optical laser power to optimal operating condition or to equalize optical power across WDM wavelengths. Attenuators come in several forms to suite a variety of applications. With fixed gain attenuators, there are build out types (male to female), adaptor types (female to female), and inline type (build in as part of patch cord). The accuracy and stability of attenuation value over operation temperature range are critical in live telecom networks. w-Ignite™ attenuator product family offers high precision with either air gap or attenuation fiber technologies. All three packaging forms are available with various attenuation values.

### Build-out Type (Male to Female) Attenuators

w-Ignite build-out type attenuators are installed between an adaptor and a connector. They are doped fiber attenuators with exceptional optical performance and reliability.

### Bulkhead Type (Female to Female) Attenuators

w-Ignite bulkhead type attenuators are installed between connectors or installed inside fiber panels. They are air-gapped based attenuators with high performance and reliability.



*SC Attenuator (build-out)*



*FC Attenuator (build-out)*



*Hardshell Loop-Back Attenuator*



*LC Attenuator (build-out)*



*FC Attenuator (bulkhead)*



*SC Attenuator (bulkhead)*

## Features

- Connector Types: FC, SC, LC, MU
- Polish: UPC and APC
- Wavelengths: 1310nm or 1550nm or both
- Attenuation Range: 1dB to 25dB

## Benefits

- Environmentally stable
- •Easy installation
- Low return loss
- Readily panel mountable
- Compact packaging

## Fixed Adaptor Type Attenuators

- FC Build-out Type Attenuator
- LC Build-out Type Attenuator

## Applications

- • Telecom and data networks
- Power equalization in DWDM networks
- CATV and multimedia applications
- Testing instruments
- Fiber to the Home
- Multi-channel subscriber loop
- Optical transmission system

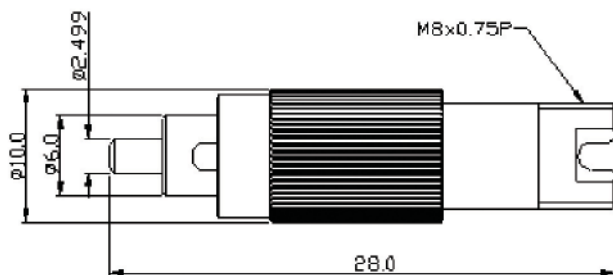

## Environmental Compliance

- Telcordia GR-326-CORE
- TIA/EIA-568B-B.3 Fiber Optic Cabling Component Standard
- IEE802.3z Standard for Fiber Optic Cabling
- RoHS Certified for European market requirements

Specifications			
Operating Wavelength (nm)	1240~1620		
Attenuation Tolerance	Under $\pm 0.5$ dB (0dB~10dB) $\leq 10\%$ ( $>10$ dB)		
Return Loss (dB)	PC	UPC	APC
	Under -45	Under -55	Under -65
Fiber Type	SM: 9/125um	MM: 50/125um, 62.5/125um	
Operating Temperature (C°)	-40 ~ +80		

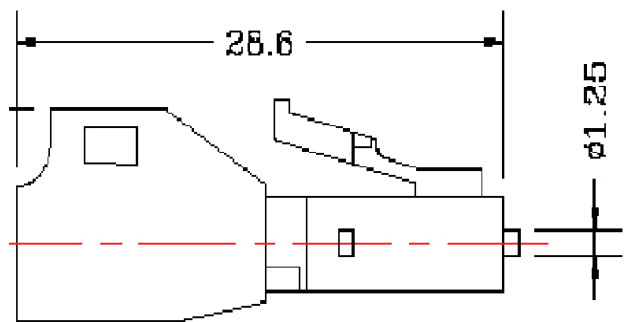

**Wave2Wave** provides business essential infrastructure solutions that enable leading enterprises to unlock and realize the benefits of next generation data center technologies. Our data center product families include environmentally friendly and smart network cabling, modular and cost-efficient data centers, optical wavelength management systems and intelligent network infrastructure management software. Our products and solutions serve enterprise, government, military and service provider customers and markets in their mission critical data center and IT applications.



Headquarters: 517 Fairview Way Milpitas, CA 95035 • Website: [www.wave-2-wave.com](http://www.wave-2-wave.com)  
 Email: [sales@wave-2-wave.com](mailto:sales@wave-2-wave.com) • Phone: (877) 223-2296 • Technical Assistance: (408) 586-8800

© 2011 Wave2Wave Solution Corp. All rights reserved. w-ignite, w-intense, w-Lucid, w-Metro, w-MetroExpress, w-MetroMono, w-MetroVault, w-MetroXtreme, w-SphereWorks and Bringing Data Centers to Life are trademarks or registered trademarks of Wave2Wave Solution Corporation. All other company and product names may be trademarks or registered trademarks of their respective companies. Features and specifications are not guaranteed to be accurate and are subject to change without notice. [032311-SCW]